

POST FRAME BUILDING WALL RETROFIT

- IDEAL INSULATION FOR POST FRAME BUILDING APPLICATIONS
- QUICK AND EASY TO INSTALL
- REDUCES HEAT LOSS AND HEAT GAIN ALL YEAR ROUND
- WILL BLOCK UP TO 96% OF RADIANT HEAT TRANSFER

INSTALLATION METHOD

1. Install furring strips parallel with the wall posts (spaced 24" on center).
2. Unroll EcoFoil® insulation horizontally - in the direction of the furring strips - and staple into place to the furring strips.
3. Run subsequent EcoFoil® Insulation and butt it up to the previous installed layer
3. To ensure a continuous insulation system, seal all seams and butt joints with EcoFoil® tape.

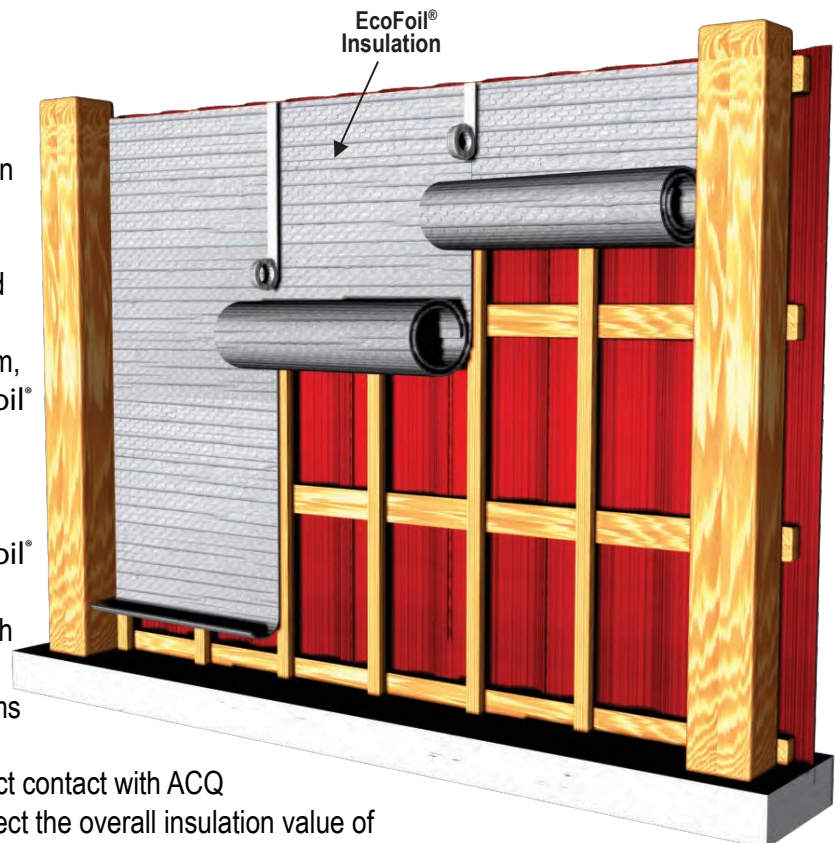

Builder's Notes:

- If a white interior finish is desired, EcoFoil® white reflective insulation may be used. Install as per usual method, however with white side facing interior.
- Use EcoFoil® white tape to seal all seams and butt joints.
- When EcoFoil® insulation comes in direct contact with ACQ lumber, it may discolour. This will not affect the overall insulation value of EcoFoil® insulation.

SUGGESTED PRODUCTS FOR THIS APPLICATION:

EcoFoil® Insulation Product	EF2210, EF2510, EF2220, EF2520 (Available in Various Dimensions)
EcoFoil® Tape	EF15073 (Reflective), EF15853 (White Poly)

- a) Check local building codes for compliance before installation. This installation sheet is intended solely to illustrate the proper location and placement of EcoFoil® Reflective Insulation products in specific constructions applications. They are not intended to illustrate proper construction methods (which is ultimately the responsibility of the builder or contractor). The installation instructions are only recommendations relating to the location and placement of EcoFoil® Reflective Insulation products and EcoFoil® makes no claims that these construction systems are universally accurate.
- b) All warranties are void if EcoFoil® Reflective Insulation products are used in exterior applications, or in non-enclosed systems or buildings.
- c) Exercise caution when using EcoFoil® Reflective Insulation products near and around electrical wiring and devices.

