

**METAL BUILDING RETROFIT  
(Wall Installation)**

- IDEAL INSULATION FOR METAL FRAME BUILDING APPLICATIONS
- QUICK AND EASY TO INSTALL
- REDUCES HEAT LOSS AND HEAT GAIN ALL YEAR ROUND
- WILL BLOCK UP TO 96% OF RADIANT HEAT TRANSFER

**INSTALLATION METHOD: (Cold Climate Application)**

1. Install 1 "x 2" furring strips on the inside and perpendicular to the girts on 24" centers.
2. Unroll the EcoFoil® Insulation parallel to the furring strips.
3. Staple the edges of the EcoFoil® Insulation to the center of the furring strips.
4. Seal seams with EcoFoil® tape.

**Builder's Notes:**

- If a white interior finish is desired, white EcoFoil® reflective insulation may be used. Install as per usual method, however with white side facing interior.
- Use EcoFoil® white tape to seal all seams and butt joints.
- When EcoFoil® insulation comes in direct contact with ACQ lumber, it may discolour. This will not affect the overall insulation value of EcoFoil® insulation.

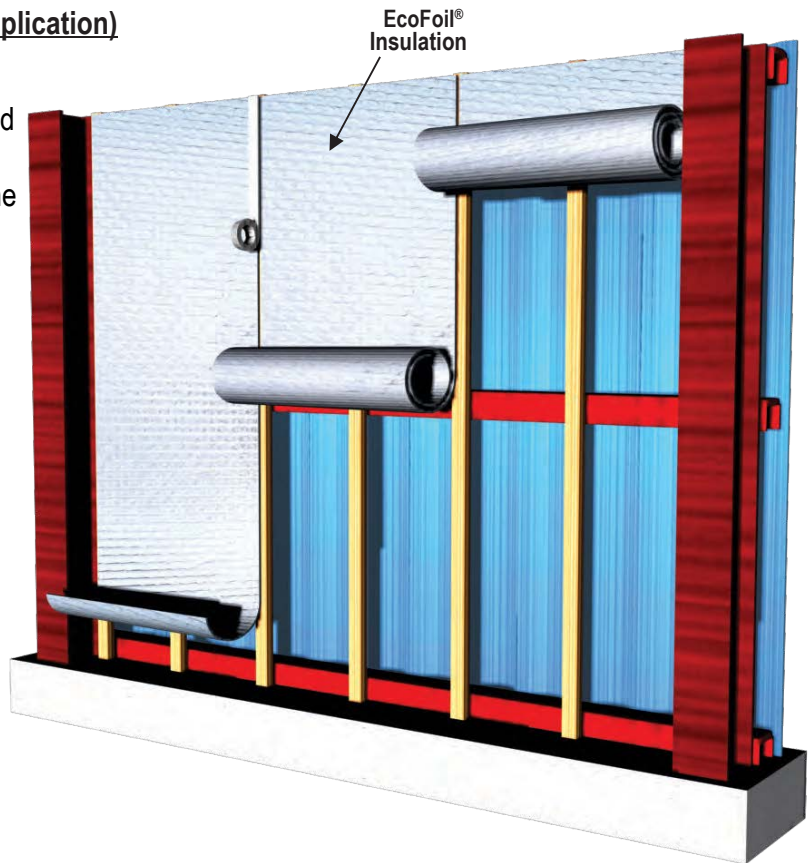

**SUGGESTED PRODUCTS FOR THIS APPLICATION:**

<b>EcoFoil® Insulation Product</b>	EF2210, EF2220, EF2510 or EF2520 (Available in Various Dimensions)
<b>EcoFoil® Tape</b>	EF15073 (Reflective), EF15853 (White Poly)

- a) Check local building codes for compliance before installation. This installation sheet is intended solely to illustrate the proper location and placement of EcoFoil® Reflective Insulation products in specific constructions applications. They are not intended to illustrate proper construction methods (which is ultimately the responsibility of the builder or contractor). The installation instructions are only recommendations relating to the location and placement of EcoFoil® Reflective Insulation products and EcoFoil® makes no claims that these construction systems are universally accurate.
- b) All warranties are void if EcoFoil® Reflective Insulation products are used in exterior applications, or in non-enclosed systems or buildings.
- c) Exercise caution when using EcoFoil® Reflective Insulation products near and around electrical wiring and devices.

