

INSTALLATION SHEET

Metal Building New Wall

PRODUCT: Double Bubble Foil/Foil or White/Foil Insulation

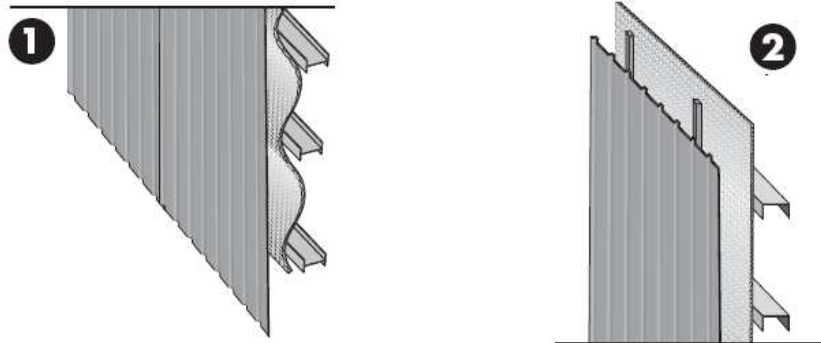

Benefits:

- Quick, clean and easy to install
- Reduces Radiant Heat loss/gain and adds R-Value
- Unaffected by condensation and humidity
- Excellent Vapor Barrier

Installation Method:

Drape Method

1. Starting at one end of the building, fasten the Double Bubble Insulation to the first framing channel using double sided tape or glue.
2. Roll out the Bubble Insulation allowing it to sag between channels creating approx. 1" air space.
3. Seal all seams with Reflective Foil / White Tape.
4. Attach metal wall panels as typically installed.

Purlins Method

1. Start at end purlin. Attach Bubble Insulation with double sided tape or glue.
2. Unroll the Double Bubble Insulation pulling tightly across the wall framing.
3. Seal seams with Reflective Foil / White Tape.
4. Attach wood or metal furring strips over the Double Bubble Insulation to create a thermal block.
5. Attach metal siding panels as typically installed.

